

**YANMAR**

SV100-7

COMPACT EQUIPMENT ULTRA-TIGHT TAIL MINI EXCAVATOR



*Some features shown may be optional or not available.

Top mobility and raw power in the 10-ton class.

The SV100-7 might surprise you. Yes, you know its 72-HP Tier 4 Final YANMAR diesel engine provides the power, digging force and lifting capacity you need to take on the tough jobs. But Yanmar also builds the SV100-7 with an ultra-tight turning radius to navigate tight, confined jobsites that provide so much trouble for bigger excavators. It doesn't stop there. The SV100-7 comes standard with 2-Pump Load Sensing hydraulic system, directing hydraulic flow where it's most needed and allowing for higher speeds and maximum fuel efficiency. Plus, you can work in more comfort with the spacious operator area, 7-inch color display, improved visibility and more.

QUICK SPECS

Weight	Horsepower	Max Dig Depth
21,671 lbs	72 hp	14' 11"

INNOVATIVE FEATURES



Unbeatable Cab Comfort

Work in comfort with a quieter and more spacious operator area outfitted with ergonomic controls and a 7-inch color display. Keep an eye on your surroundings with increased visibility from more glass area and standard side and rear cameras.



Efficient 2PLS Hydraulics

Take advantage of fuel savings with no sacrifice to power. Yanmar outfits the SV100-7 with 2PLS hydraulics for a 13% reduction in fuel consumption combined with an extraordinary boost in machine performance, productivity and travel speeds.



Convenient Maintenance Access

Complete maintenance work and refueling quickly and efficiently with an engine bay designed for maximum accessibility. The open cabin hoods put the generator, valves, radiator, oil-water separator and more right at your fingertips.

Dimensions - SV100-7

A 14 ft. 11 in. (4,570 mm)	M 8 ft. 9 in. (2,670 mm)
B 15 ft. 10 in. (4,830 mm)	N 9 ft. (2,750 mm)
C 13 ft. 9 in. (4,210 mm)	O 5 ft. 6 in. (1,690 mm)
D 24 ft. 8 in. (7,530 mm)	P 16 ft. 8 in. (5,090 mm)
E 24 ft. 1 in. (7,360 mm)	Q 25 ft. 3 in. (7,710 mm)
F 21 ft. 1 in. (6,440 mm)	R 7 ft. 7 in. (2,320 mm)
G 16 ft. 1 in. (4,910 mm)	S 6 ft. 1 in. (1,870 mm)
H 6 ft. 8 in. (2,050 mm)	T 1 ft. 4 in. (475 mm)
I 10 ft. (3,060 mm)	U 1 ft. 4 in. (410 mm)
J 7 ft. 3 in. (2,210 mm)	V 2 ft. 7 in. (795 mm)
K 1 ft. 7 in. (500 mm)	W 1 ft. 11 in. (595 mm)
L 1 ft. 7 in. (500 mm)	X 5.5 in. (135 mm)

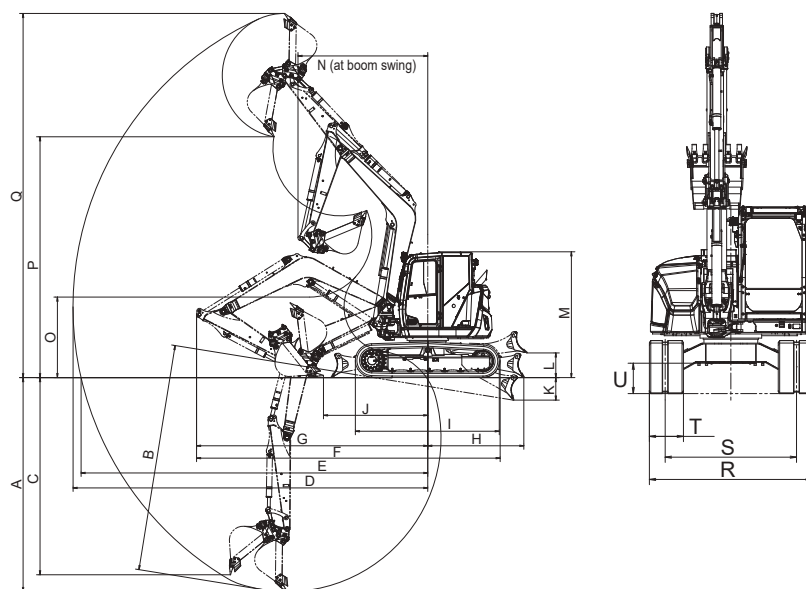
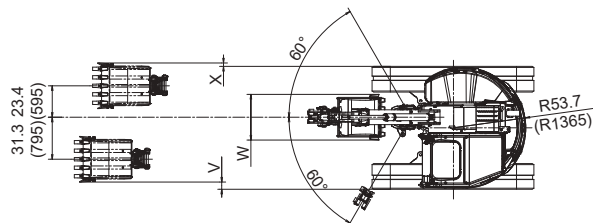

Specifications

Model			SV100-7	
Type			Cab. Rubber Track	Cab. Steel Track
Operating Weight			lbs (t)	
			21,671 (9.8)	21,914 (9.9)
Engine	Type	-	Vertical water-cooled 4-cylinder diesel	
	Model	-	4TNV98CT-VBV2	
	Output	HP (kW)/rpm	72 (53.7) / 2100	
Performance	Max Digging Force, Bucket / Arm	lbs (kN)	12,027 (53.5) / 9,487 (42.2)	
	Traveling Speed, High / Low	MPH (km / h)	2.7 (4.3) / 1.3 (2.1) 2.5 (4.0) / 1.2 (2.0)	
	Swing Speed	RPM	9.0	
	Boom Swing Angle, (L / R)	degrees	60° / 60°	
	Gradability	degrees	25°	
Ground Contact Pressure			PSI (kPa)	
			5.5 (38.1)	5.7 (39.1)
Hydraulic System	Pump Capacity	GPM (L / min)	36.4 (137.8) x 2 (variable) · 5.5 (21) x 1 (gear)	
	Main Relief Set Pressure	PSI (MPa)	3988 (27.5) x 2 · 493 (3.4) x 1	
Blade Dimensions	Width x Height	ft-in (mm)	7'7" (2,320) x 1'8" (520)	
	Working Area of Blade (Upper/Lower)	ft-in (mm)	1'7" (485) / 1'7" (485)	
Fuel tank capacity			Gals (L)	
			30.9 (117)	

Hydraulic PTO

Model			SV100-7	
			GPM (L / min)	
Output			AUX1 2100RPM	
Specification			AUX2 2100RPM	
Combined Flow, Double Actions			26.4 (100)	18.5 (70)

Lifting Capacity

LIFT POINT HEIGHT h:in (mm)	r:REACH in (mm)											
	RATED LIFT CAPACITY OVER END BLADE DOWN				RATED LIFT CAPACITY OVER END BLADE UP				RATED LIFT CAPACITY OVER SIDE BLADE DOWN			
	lbs (kg)				lbs (kg)				lbs (kg)			
	MAX	16'5" (5,000)	13'1" (4,000)	9'10" (3,000)	MAX	16'5" (5,000)	13'1" (4,000)	9'10" (3,000)	MAX	16'5" (5,000)	13'1" (4,000)	9'10" (3,000)
196.9 (5,000)	4,233 (1,920)		3,968 (1,800)		4,145 (1,880)		3,924 (1,780)		4,189 (1,900)		3,880 (1,760)	
157.5 (4,000)	4,123 (1,870)	4,034 (1,830)	4,123 (1,870)		3,373 (1,530)	4,056 (1,840)	4,123 (1,870)		2,954 (1,340)	3,990 (1,810)	4,056 (1,840)	
118.1 (3,000)	4,145 (1,880)	4,343 (1,970)	4,894 (2,220)	5,997 (2,720)	3,042 (1,380)	4,299 (1,950)	4,872 (2,210)	5,842 (2,650)	2,579 (1,170)	3,395 (1,540)	4,828 (2,190)	5,842 (2,650)
78.7 (2,000)	4,145 (1,880)	4,872 (2,210)	5,820 (2,640)	8,400 (3,810)	2,800 (1,270)	3,748 (1,700)	5,776 (2,620)	8,444 (3,830)	2,403 (1,090)	3,263 (1,480)	4,586 (2,080)	8,444 (3,830)
39.4 (1,000)	4,321 (1,960)	5,269 (2,390)	6,967 (3,160)	9,788 (4,440)	2,756 (1,250)	3,638 (1,650)	5,159 (2,340)	7,606 (3,450)	2,359 (1,070)	3,153 (1,430)	4,299 (1,950)	7,606 (3,450)
Ground (0)	4,387 (1,990)	5,578 (2,530)	7,231 (3,280)	10,163 (4,610)	2,800 (1,270)	3,571 (1,620)	4,938 (2,240)	7,341 (3,330)	2,425 (1,100)	3,064 (1,390)	4,145 (1,880)	7,341 (3,330)
-39.4 (-1,000)	4,409 (2,000)	5,225 (2,370)	6,967 (3,160)	9,546 (4,330)	3,108 (1,410)	3,527 (1,600)	4,828 (2,190)	7,319 (3,320)	2,668 (1,210)	3,042 (1,380)	4,079 (1,850)	7,319 (3,320)
-78.7 (-2,000)	4,387 (1,990)		6,041 (2,740)	8,201 (3,720)	3,770 (1,710)		4,938 (2,240)	8,289 (3,260)	3,263 (1,480)		4,123 (1,870)	8,289 (3,260)

Standard Equipment

Double Lock Quick Coupler
 Blade with Float
 Boom Swing Function
 Rubber Tracks
 Flow Selector Valve on AUX1 Circuit
 Antenna and Pre-wired for Radio
 Right Side and Rear View Cameras
 4-Way Multi Pattern Control
 LCD Passcode Function
 Windshield Washer
 Air Conditioner
 Defroster
 Joystick Pilot Controls
 Suspension and Reclining Seat
 Seat Belt
 Proportional Auxiliary Controls
 Automatic 2-Speed Travel
 Auto Decel Switch
 Eco Mode Switch
 Traveling Alarm
 Floor Mats

Please note that the standard equipment may vary from this list. Consult your Yanmar dealer for confirmation.

Find more information on the SV100-7 at YanmarCE.com.